

Los autobuses shuttle de DART proporcionarán servicios a las estaciones afectadas. Los viajeros subirán y bajarán en las paradas de autobús rojas de “Rail Disruption,” que están localizadas cerca a cada estación.

Se operarán cinco rutas separadas, incluyendo el servicio express entre la Pearl/Arts District y la Union Station (vea el mapa).

Se recomienda que los pasajeros que viajan en estos fines de semana concedan bastante tiempo extra, especialmente si su viaje incluye transferencias de tren a autobús. Los retrasos pueden también afectar a los aficionados que asisten a los eventos en American Airlines Center durante el fin de semana, así como los que participan en el Capital One Bank Dallas YMCA Turkey Trot durante el Día de acción de gracias.

El servicio normal de los fines de semana se reanudará a tiempo para la Children’s Medical Center Holiday Parade anual.

Actualizaciones al proyecto y servicio estarán disponibles en DART.org.

Los viajeros subirán y bajarán en las paradas de autobús rojas de “Rail Disruption,” que están localizadas cerca a cada estación.

**In case of rail service disruption, board temporary shuttle buses here**

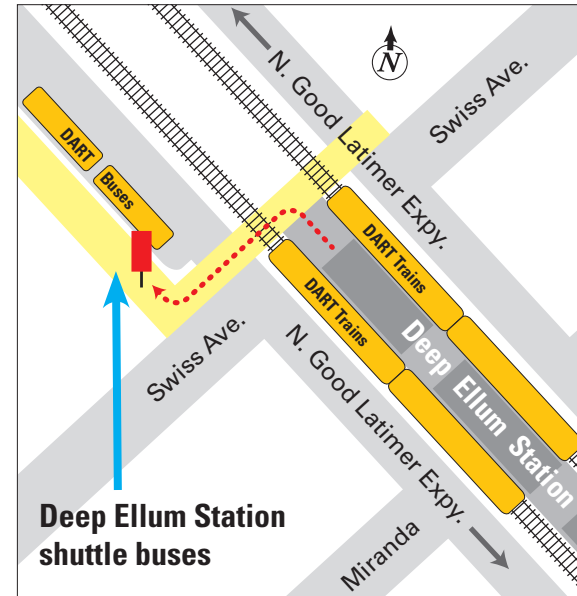
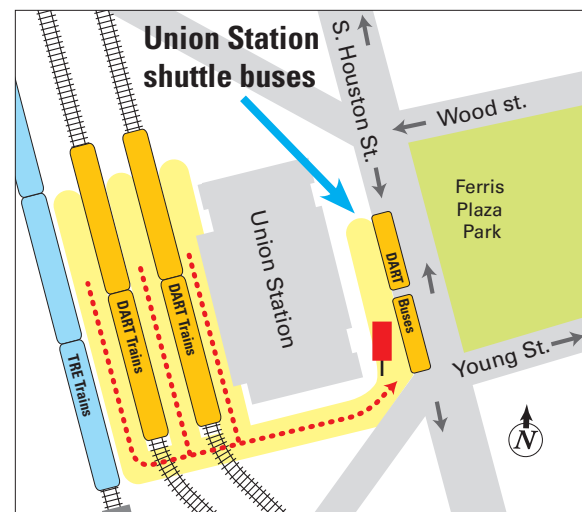
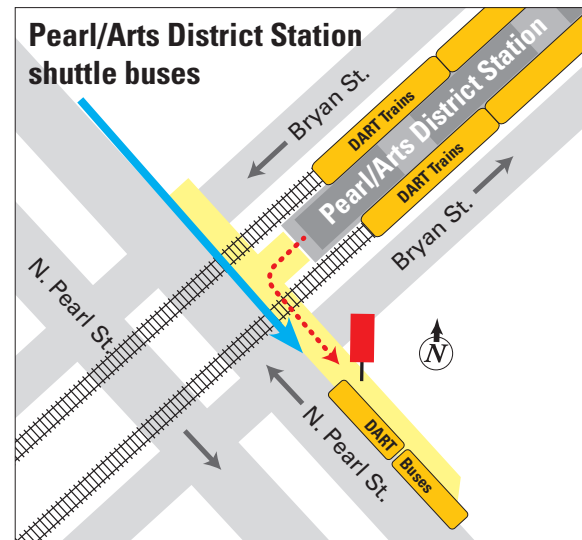
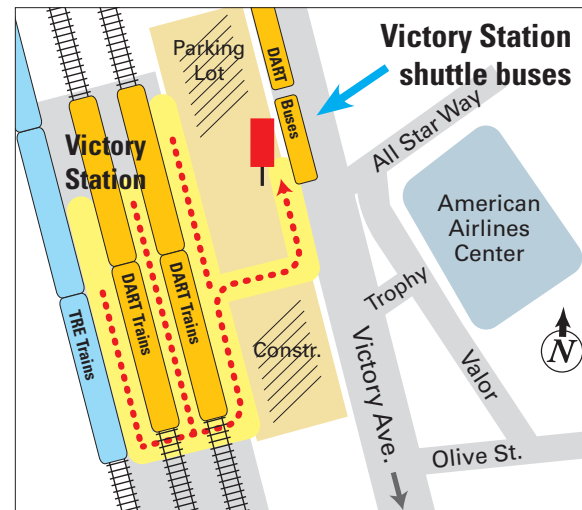

**Bus shuttle headsign route colors and route numbers\***

Union Station – Pearl/Arts District (*Express*)  
**SHUTTLE ROUTE 831**

Union Station - West End - Akard - St. Paul - Pearl/Arts District - Deep Ellum (*Local*)  
**SHUTTLE ROUTE 832**

Victory - Pearl/Arts District - Deep Ellum (*Express*)  
**SHUTTLE ROUTE 833**

Victory - West End - Akard - St. Paul - Pearl/Arts District - Deep Ellum (*Local*)  
**SHUTTLE ROUTE 834**

Union Station - Victory  
**SHUTTLE ROUTE 835**

*\*for track replacement only*

GoPass™ Trip planning and easy payment with GoPass™.

**DART** DART.org

For questions or concerns, call DART Customer Information at 214.979.1111

Follow us on Twitter | Like us on Facebook

# Rail Service Interruption Notice

## Downtown Dallas Only

October 25 – November 30, 2014  
(weekends only)

**B**eginning Saturday, October 25, for six weekends, and concluding Sunday, November 30, DART Rail in Downtown Dallas will be discontinued each weekend to allow track replacement along Pacific Avenue and Bryan Street. DART shuttle buses will connect the affected stations.

### Interrupted Rail Segments:

- **Red** and **Blue** lines – between Union Station and Pearl/Arts District Station
- **Green** Line – between Victory Station and Deep Ellum Station
- **Orange** Line – between Victory Station and LBJ/Central Station\*

(\*only **Red** Line will operate on the Pearl Arts District-LBJ/Central portion of the **Orange** Line on these days.)

DART shuttle buses will serve the affected stations. Buses will load and unload at the red “Rail Disruption” bus stops located near each station.

**Five separate routes will be in operation**, including express service between Pearl/Arts District and Union Station (see map).

Passengers traveling on these weekends are strongly encouraged to allow plenty of extra time, especially if rail-to-bus transfers are involved. Fans attending weekend events at American Airlines Center, as well as participants in the Capital One Bank Dallas YMCA Turkey Trot on Thanksgiving Day may also be impacted by delays.

Normal weekend service is scheduled to resume in time for the annual Children’s Medical Center Holiday Parade.

Service and project updates will be available on [DART.org](http://DART.org).

**Shuttle Bus Routes** See bus shuttle headsign colors on reverse side.

- 831** ●●●●● Union Station – Pearl/Arts District (express)
- 832** ●●●●● Union Station – West End – Akard – St. Paul – Pearl/Arts District – Deep Ellum (local)
- 833** ●●●●● Victory – Pearl/Arts District – Deep Ellum (express)
- 834** ●●●●● Victory – West End – Akard – St. Paul – Pearl/Arts District – Deep Ellum (local)
- 835** ●●●●● Union Station – Victory (express)

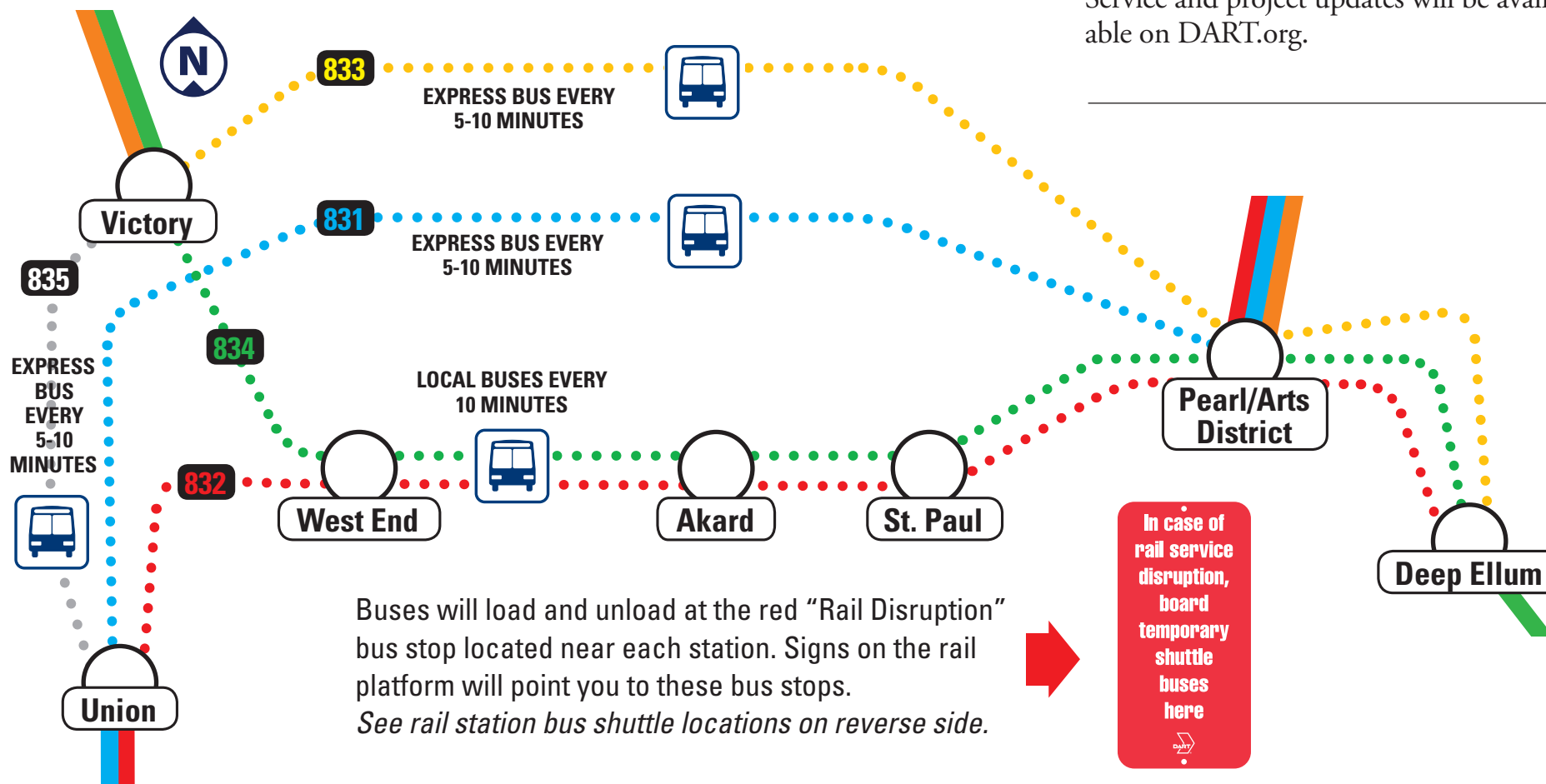

Buses will load and unload at the red “Rail Disruption” bus stop located near each station. Signs on the rail platform will point you to these bus stops. See rail station bus shuttle locations on reverse side.

# Aviso de interrupción del servicio de tren

Solamente en Downtown Dallas



Del 25 de octubre al 30 de noviembre, 2014 (solamente los fines de semana)

**A** partir del sábado, 25 de octubre (durante seis fines de semana) y terminando el domingo, 30 de noviembre, el tren DART en Downtown Dallas se desconectará cada fin de semana para permitir el reemplazo de las vías entre Pacific Avenue y Bryan Street. Los autobuses shuttle de DART conectarán las estaciones afectadas.

Segmentos de tren interrumpidos:

- Las **Líneas Roja y Azul (Red and Blue Lines)** - entre la Union Station y la Pearl/Arts District Station
- La **Línea Verde (Green Line)** - entre la Victory Station y la Deep Ellum Station
- La **Línea Naranja (Orange Line)** - entre la Victory Station y la LBJ/Central Station\*

(\*solo la **Línea Roja [Red Line]** operará en la porción de Pearl/Arts District-LBJ/ Central de la **Línea Naranja [Orange Line]** en estos días)